

TOP VIEW

1:5

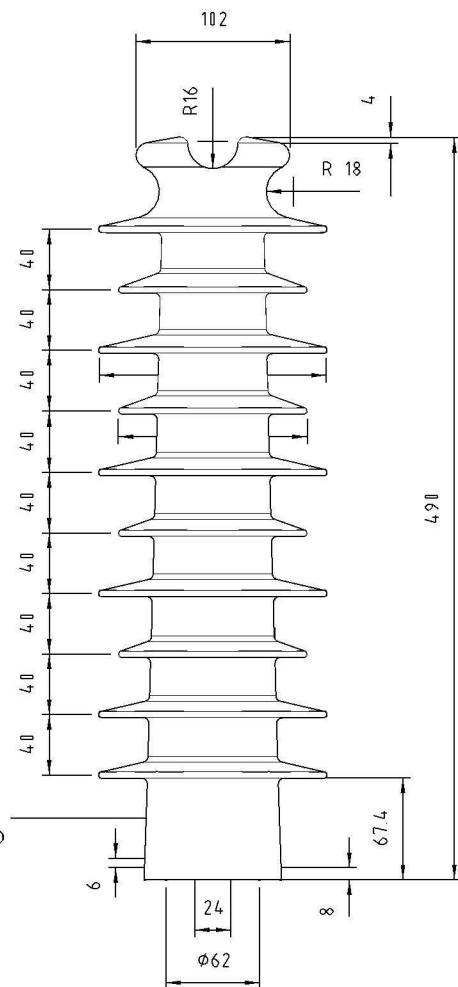

FRONT ELEVATION

1:5

M24 STEEL INSERT FOR GALVANISED STUD



ISOMETRIC VIEW

N.T.S.

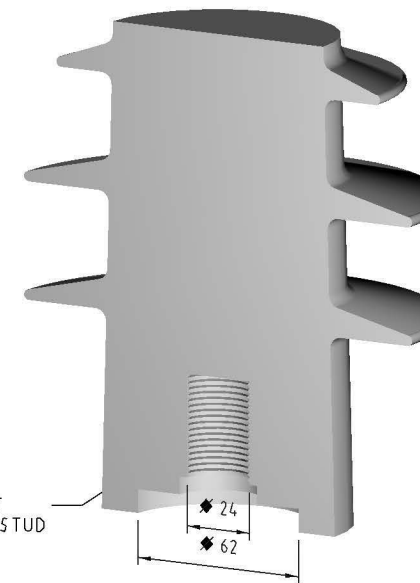

CUT ISOMETRIC VIEW

N.T.S.

M24 STEEL INSERT FOR GALVANISED STUD

NOTE:

1. ALL DIMENSIONS AS PER AS29472.2 UNLESS OTHERWISE NOTED

**CYCLOALIPHATIC
VERTICAL LINE POST INSULATOR
ITEM NUMBER: 300467**

BRIEF SPECIFICATION	
HIGHEST VOLTAGE FOR EQUIPMENT (kV)	24kV
LINE VOLTAGE (kV)	22kV
IMPULSE WITHSTAND VOLTAGE (kV)	150kV
DRY POWER FREQUENCY WITHSTAND VOLTAGE (kV)	90kV
WET POWER FREQUENCY WITHSTAND VOLTAGE (kV)	73kV
DRY ARC DISTANCE	480mm
CREEPAGE	1020mm
CANTILEVER (kN)	11kN
MINIMUM TENSILE FAILING LOAD	>20kN
WEIGHT (APPROXIMATE)	5kg

						DES M. BOCK		POWER STANDARD DRAWING		
						DRN A. SCHMID		INSULATORS LINE POST CYCLOALIPHATIC 22KV COMPLETE		
						CKD M. BOCK				
						APPD C. FOO				
						SCALE AS SHOWN				
						ISSUED MARCH 2002		A3	DRAWING NUMBER	S01-01-03-10
						ALL DIM. IN mm				
						DRAFTING STANDARD TO A.S.1100		CAD PRODUCT - DO NOT AMEND MANUALLY		AMDT
2	TITLEBLOCK & DRAWING NUMBER FORMATTED	K.T.	MAR'19	C.C.	C.C.					
1	NOTE ADDED & UPDATED TO 3D MODEL	C.C.	DEC'18	B.V.	B.C.					
0	ISSUED FOR CONSTRUCTION	A.S.	MAR'02	F.R.	-					
NO	DESCRIPTION	DRN	DATE	CKD	APPD					
AMENDMENTS										

